

# BOAT SHUTTLE BOBBIN WINDER

## Wooden

### Before Commencing

Read the instructions completely, identify the parts and note the assembly sequence. Then use the fine sandpaper supplied to remove any sharp corners or edges.

### Finishing the Wood

We recommend that the wood surfaces be waxed or oiled before assembly. This protects the wood from climatic changes and enhances the beauty of the wood.

### For the Ultimate Finish

The Ashford Wax Finish will enhance the natural colour and beauty of the native New Zealand Silver Beech timber.

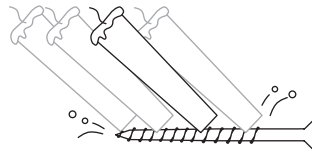
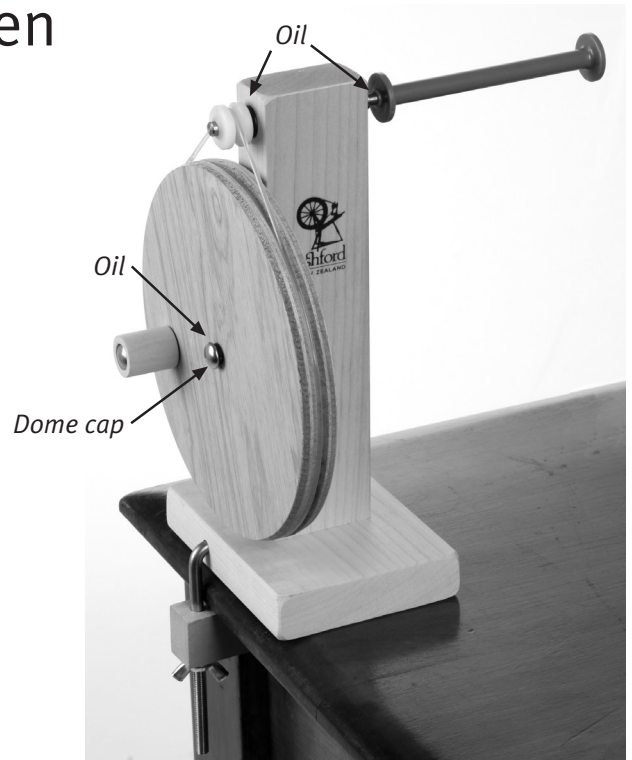

To make assembly easier use candle wax on the screws.

### Assembly

1. Attach the base to the upright with 2 x 45mm (1 $\frac{3}{4}$ " ) screws.
2. With the handle to the outside place the wheel onto the shaft and push the dome cap on.
3. Place the drive band around the wheel and spindle pulley. NOTE: Remove the drive band when not in use to avoid it stretching.
4. Apply a drop of oil occasionally to the shaft and wheel bearings.
5. Assemble the clamp as illustrated.
6. Clamp your boat shuttle bobbin winder to a bench or table.
7. Slide a bobbin onto the tapered shaft until tight.
8. Wind your yarn onto the bobbin.

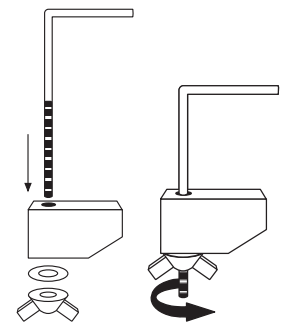

Clamps

*Happy Weaving!*

### Other Ashford weaving accessories:

Boat shuttle bobbins - available in packs of 10  
Boat shuttles - includes 1 bobbin

BSBWW070518V4

### Ashford Guarantee

Thank you for purchasing this Ashford product. In the unlikely event there is any fault in manufacture we will replace the item. To validate our guarantee please visit our website or write to us.